

Tanglewood Events

CREATE AN UNFORGETTABLE EXPERIENCE
IN ICONIC VENUES



Weddings & Celebrations
Meetings & Corporate Events
Performances, Film & Recordings



WELCOME TO TANGLEWOOD

Bring the magic and history of Tanglewood to your next event.

Tanglewood has been the summer home of the Boston Symphony Orchestra since 1937. Comprising more than 400 acres of landscaped grounds, formal gardens, and rolling meadows in the towns of Lenox and Stockbridge, Tanglewood was once the country estate of Boston banker William Aspinwall Tappan. The Property, including the Main House which is still in use today, was given to the Boston Symphony Orchestra by Tappan's daughter, Mary, and her niece Mrs. Gorham Brooks. Although Tanglewood welcomes more than 300,000 visitors each year, its beauty and tranquility remain unchanged.

Our numerous event spaces offer a wide range of capacity and ambience. For more information and bookings, please visit tanglewood.org/events or contact Events Services at 617-638-9240.

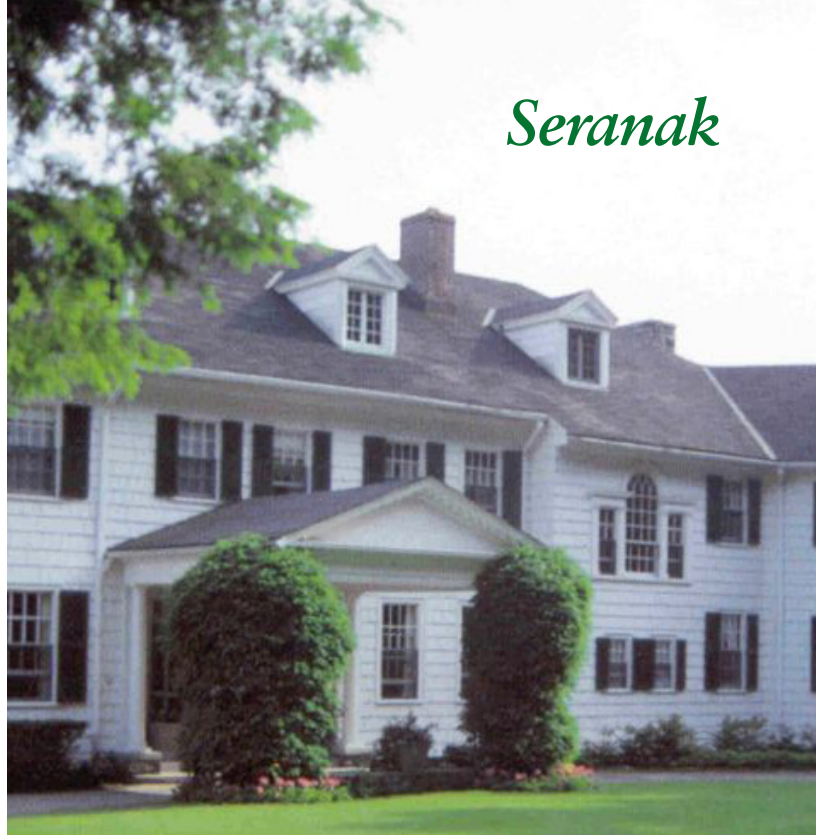

Seranak



SERANAK

Seranak offers a magnificent setting for the various artistic and social gatherings that support the vibrant life of the Boston Symphony Orchestra. Offering magnificent views of Lake Mahkeenac (Stockbridge Bowl), Seranak sits on 170 acres and was built in 1913. After leading the BSO's first concerts in the Berkshires some three years earlier, Serge Koussevitzky purchased the property in 1939, and in 1940, founded the Berkshire Music Center, now the Tanglewood Music Center. Today, Seranak remains much the same as when the Koussevitzkys resided here. In the music room, there is a life-sized portrait of Koussevitzky playing the double bass, the instrument on which he was a virtuoso prior to his conducting days. His study abounds with historic photographs and letters, along with a plaster cast of his left hand positioned to play the double bass.

100–150 people seated

Highwood



HIGHWOOD

Highwood, one of the earliest of the famous Berkshire estates, includes a twenty-room manor house that was built in 1846. The BSO acquired the 120 acres of Highwood in 1987, and under a master plan designed by the firm of Carr, Lynch, Hack & Sandell, the adjoining Highwood and Tanglewood estates were rejoined into the single entity they were originally. Highwood Manor is now used to serve dinner on Friday and Saturday, and brunch on Sunday, during the Tanglewood season, and is also available for private functions seasonally. The views across the lawn to the Stockbridge Bowl are breathtaking, and the manor house itself can accommodate up to 150 people, with the option of renting an outdoor tent to increase capacity to 450 people.

150–450 people seated



Rental Tents at Tanglewood

RENTAL TENTS AT TANGLEWOOD

Renting a tent is a great way to keep your guests comfortable rain or shine. We offer rentals of the Hawthorne Tent, near the Whispering Bench (seated dinner capacity: 400) or Formal Gardens Tent, near the Copland Ellipse (seated dinner capacity: 100), with breathtaking views of the Berkshire Mountains. Additionally, on each end of the Tanglewood summer season, we offer the Tent Club (seated dinner capacity: 400) and a variety of tent sizes can be rented next to the historic Highwood Manor House.

150–450 people seated



Chamber Music Hall



CHAMBER MUSIC HALL

The Chamber Music Hall features a rustic, open-air space that can be customized to suit all of your event plans. It is located on the grounds of Tanglewood near the Visitor Center and Tanglewood Manor House overlooking the Stockbridge Bowl.

150–200 people seated



Linde Center for Music and Learning

LINDE CENTER FOR MUSIC AND LEARNING

This four-building complex with flexible event and meeting spaces, a 150-seat Café, and state-of-the-art technology is climate-controlled and available for your event beginning Fall 2019. The largest space accommodates a wide variety of social and dining events with a seating capacity of 250, and performances, lectures, meetings, film screenings, and recording sessions with customizable seating layouts. A lobby area with restrooms and an enclosed walkway connect this studio with the Café. Two smaller studios provide additional space for multi-room or progressive events, and other educational and social activities. The Linde Center for Music and Learning is located on the Tanglewood grounds in close proximity to Ozawa Hall.



LINDE CENTER FOR MUSIC AND LEARNING

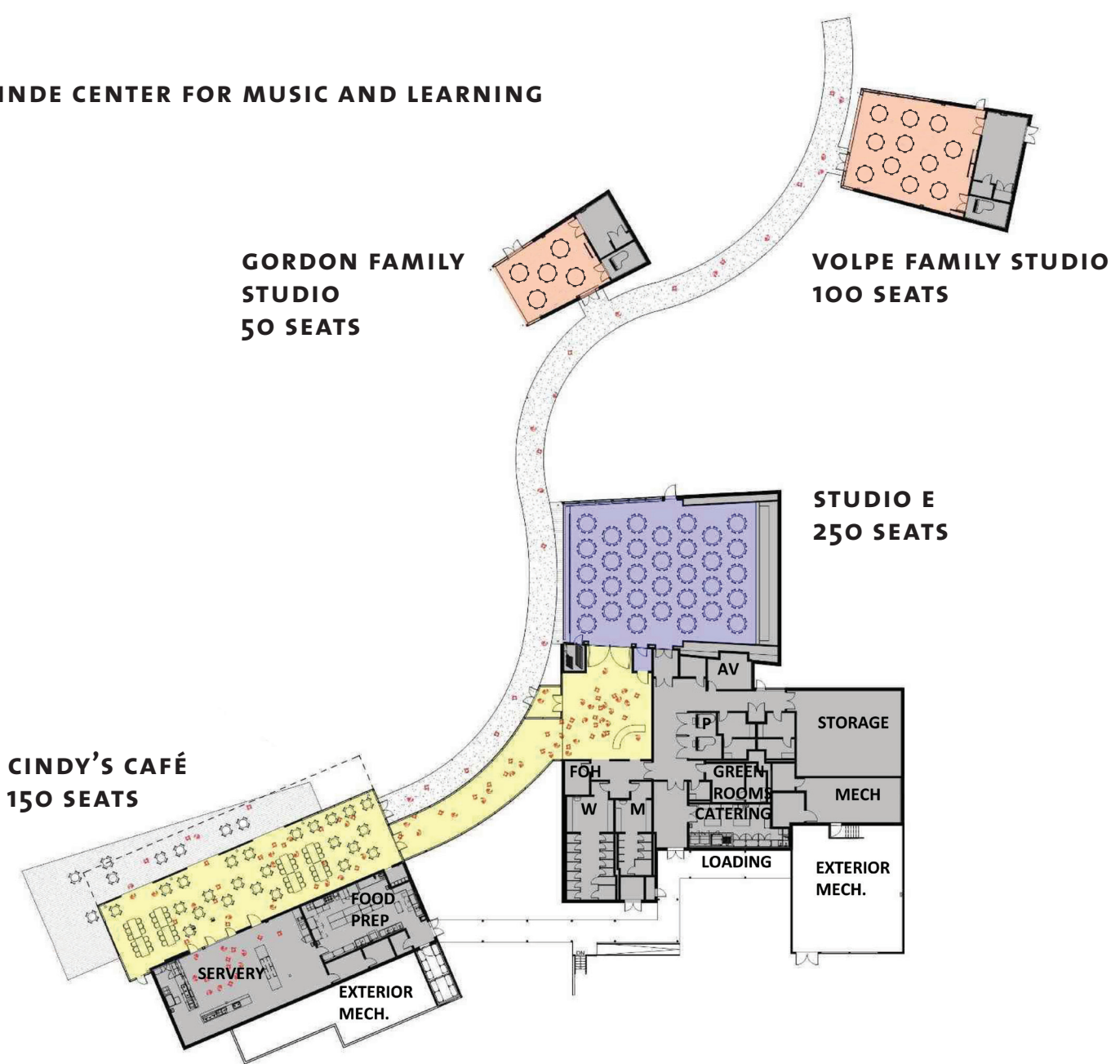



WEDDINGS AT TANGLEWOOD

The grounds of Tanglewood provide a variety of options to host the ideal wedding. Capacity options range from a small gathering of 50 up to a standing event of 450 or more, with parking available for all. Indoor spaces include high ceilings, natural light, and historical sites. Outdoor spaces feature the idyllic grounds of Tanglewood with views of the Stockbridge Bowl, manicured lawns, formal gardens, and beautiful shade trees. Additional options include a variety of tents available with everything you need to customize your event including tables, chairs, audio/visual equipment, golf carts, and more.



Photos by Tricia MacCormack



Tanglewood

GROUNDS MAP

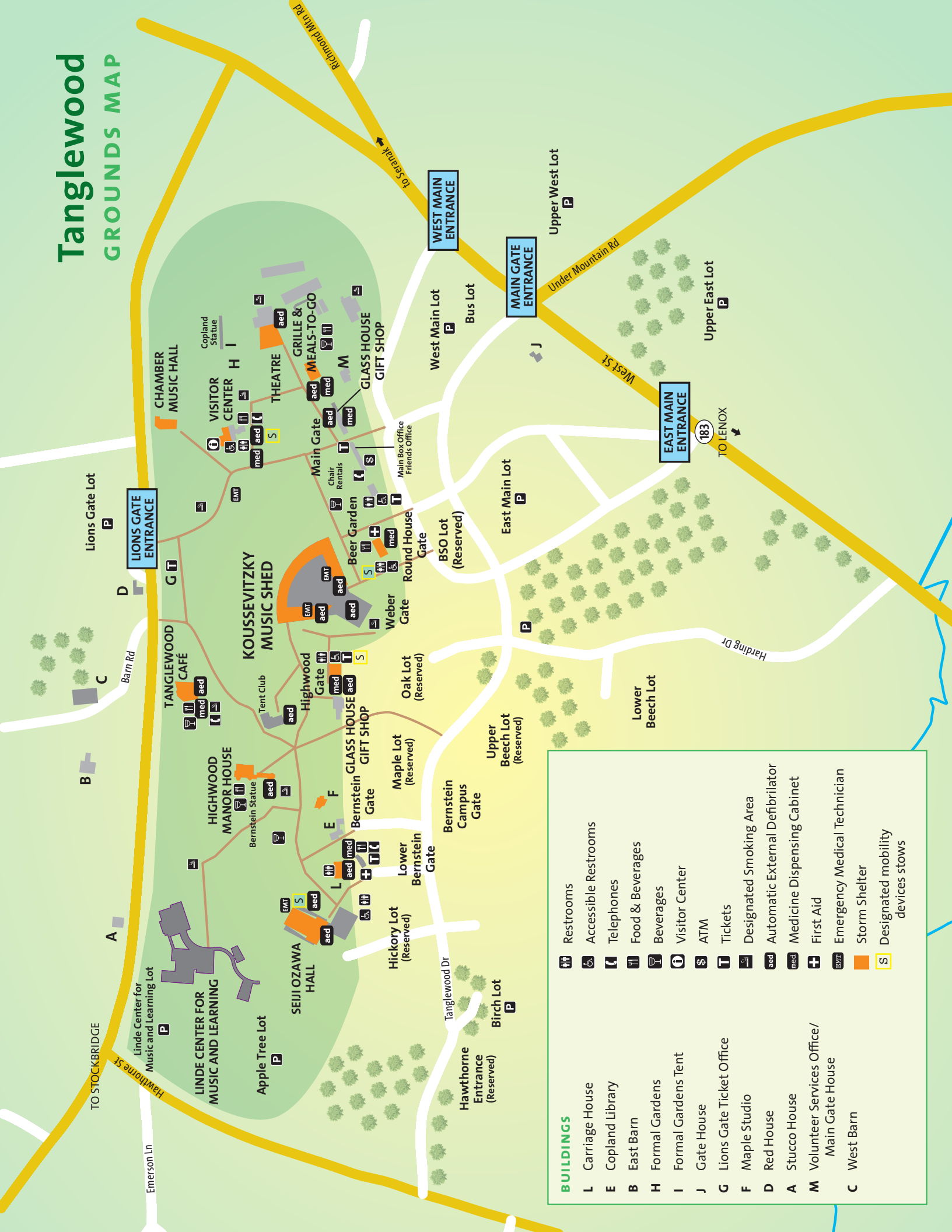

BUILDINGS

- L Carriage House
- E Copland Library
- B East Barn
- H Formal Gardens
- I Formal Gardens Tent
- J Gate House
- G Lions Gate Ticket Office
- F Maple Studio
- D Red House
- A Stucco House
- M Volunteer Services Office/
Main Gate House
- C West Barn

- Restrooms
- Accessible Restrooms
- Telephones
- Food & Beverages
- Beverages
- Visitor Center
- ATM
- Tickets
- Designated Smoking Area
- Automatic External Defibrillator
- Medicine Dispensing Cabinet
- First Aid
- Emergency Medical Technician
- Storm Shelter
- Designated mobility devices stows

Pricing

LINDE CENTER FOR MUSIC AND LEARNING (based on a 3 hour event)

Venue	Seated Capacity	Standing Capacity	Peak Pricing (May–October)	Off Peak Pricing (November–April)
Studio E	250	468	\$8,000	\$6,500
Cindy's Café	150	321	\$5,000	\$3,500
Gordon Family Studio	106	228	\$4,000	
Volpe Family Studio	53	114	\$3,000	

Tables, basic lighting, and chairs included. Please inquire about production pricing and preferred vendor list.

OTHER LOCATIONS ON THE GROUNDS May–October Seasonal Rentals

Venue	Seated Capacity	Standing Capacity	Peak Pricing	Notes
Highwood	100	150	\$6,000	Tables & chairs included, Basic AV
Tent @ Highwood · 60' x 130' (Pole)	400	450	\$5,800	Tent only
Tent @ Highwood · 60' x 100' (Pole)	350	400	\$5,000	Tent only
Tent @ Highwood · 50' x 80' (Pole)	150	200	\$4,200	Tent only
Seranak	100	150	\$7,000	Tables & chairs included, Basic AV
Tent @ Seranak · 30' x 90' (Frame)	150	200	\$11,000	Tent only
Tent @ Seranak · 30' x 60' (Pole)	100	150	\$3,000	Tent only
Chamber Studio	150	200	\$3,000	Tables & chairs included
Formal Gardens	125	175	\$1,400	Tables & chairs included, Basic AV
Hawthorne Tent (Pole)	125	175	\$3,000	Tables & chairs included, Basic AV
Kennedy Lawn (Pole)	n/a	n/a	\$1,400	Lawn space only Tables & chairs included, 4 pop-up tents
Tent Club (Pole)	350	400	\$3,000	Tables & chairs included Other tents rentable

*Tent costs include basic electric and basic lighting.
Additional costs if anything is needed above and beyond.
Inquire about our preferred vendor list.*

WEDDINGS AT TANGLEWOOD

Chamber Music Hall

\$5,000 • 150 people seated

- Includes use of Chamber Music Hall
- Tables and Chairs owned by the BSO
- Use of Tappan Porch only
- A ready space in Tappan Manor
- Use of bathrooms attached to Tappan Manor
- Parking Attendants
- The use of 2 four passenger golf carts for pictures

Tent Club

\$5,000 • 350 people seated

- Includes use of Tent Club
- Tables and Chairs owned by the BSO
- A ready space at Highwood
- Use of bathrooms attached to Tent Club
- Parking Attendants
- The use of 2 four passenger golf carts for pictures

Hawthorne Tent

\$5,000 • 400 people seated

- Includes use of Hawthorne Tent
- Tables and Chairs owned by the BSO
- A ready space in Tappan Manor
- Use of bathrooms attached to Tappan Manor
- Parking Attendants
- The use of 2 four passenger golf carts for pictures

Highwood

\$6,000 • 100 people seated

- Includes use of Highwood
- Tables and Chairs owned by the BSO
- Use of Highwood Lawn with Lawn furniture
- A ready space in Highwood
- Use of 2 bathrooms on the 1st floor of Highwood
- Parking Attendants
- The use of 2 four passenger golf carts for pictures
- Does not include Tent rental

Seranak

\$7,000 • 100 people seated

- Includes use of 1st floor, veranda
- Olga's Room for ready space
- Tables and Chairs owned by the BSO
- Use of veranda lawn with rocking chairs
- Use of 2 bathrooms on the 1st floor
- Parking Attendants
- Does not include Tent rental

Ceremony on Tappan Lawn or Highwood Lawn

\$2,000

- Includes Chairs owned by the BSO
- Includes ready space in Tappan Manor or Highwood
- Does not include tent rental

Ceremony at Seranak

\$3,000

- Includes Chairs owned by the BSO
- Includes ready space at Seranak
- Does not include tent rental

1 hour cocktail reception added on to ceremony \$1,000

Includes use of Tables and Chairs owned by BSO

Linde Center for Music and Learning

\$12,000 Peak • \$10,000 Off Peak

- Includes use of Studio E and Café
- Includes ready space in Studio E and Café
- Tables and Chairs owned by BSO
- Use of bathroom facilities
- Parking attendants
- The use of 2 four passenger golf carts for pictures (peak season only)
- State-of-the-art technology available in Studio E (priced out per event)